

LED-Einbaudownlight, IP44

Artikel-Nr. 12128023

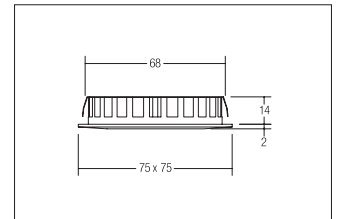

LED-Einbaudownlight, IP44, chrom, square. In a compact design, for installation in tool-less rapid assembly systems. Lamp holder: without, Mounting method: Flush mounting, Place of installation: Ceiling-mounted, material: Die-cast aluminium / Plastic, IP protection class: according to DIN EN 60529 IP44*, Protection class: (EN 61140) III, voltage: 12V, Power: 5W, amount of light sources / fittings: 1.0 Stk, Luminous flux: 375lm, Farbtemperatur: 3000K, Colour of light: white, Radiation angle: 60°, Adjustability: not adjustable, without operating, . This luminaire contains incorporated and non-exchangeable LED light sources.

Artikel-Nr.	12128023	Applications
Stand:	25.11.2020 19:03	HOME LIVING OFFICE COMMUNICATION HOTEL INDUSTRY GASTRONOMY

colour of light	3000
Colour	chrome
Radiation angle	60 °
amount of light sources / fittings	1 Qty
material	Die-cast aluminium / Plastic
Power	5 W
Lamp type	LED
shipping	inkl. 2.000 mm Anschlussleitung
Colour rendering	CRI > 80
Built-in diameter	68 mm

Built-in depth	14 mm
voltage	12V
Luminous flux	375 lm
IP protection class	IP44*
Protection class	III
Voltage type	DC
Adjustability	not adjustable
length	75 mm
Width	75 mm
Height-depth	3 mm
circuit type secondary side	parallel conduction