

LED-Einbaudownlight INDIWO74, IP44, starr
Artikel-Nr. 12275023

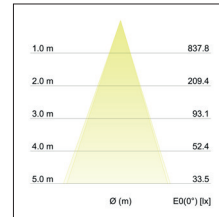
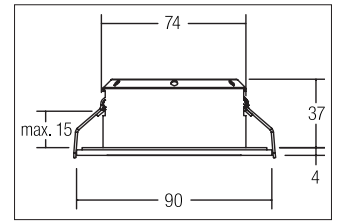
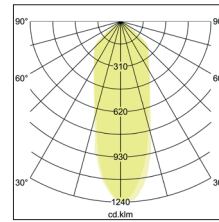

LED-Einbaudownlight INDIWO74, IP44, starr, chrom, round. In a compact design, for installation in tool-less rapid assembly systems. Einbauleuchte geeignet zur direkten Montage auf normalentflammbaren Baustoffen. Wärmedämmung zulässig. Lamp holder: Plug&Play, Mounting method: Flush mounting, Place of installation: Ceiling-mounted, material: Aluminium / Steel / Plastic, IP protection class: according to DIN EN 60529 IP44*, Protection class: (EN 61140) III, current: 350 mA, Power: 5,5W, amount of light sources / fittings: 1.0 Stk, Luminous flux: 550lm, Farbtemperatur: 3000K, Colour of light: white, Radiation angle: 36°, Adjustability: not adjustable, without operating, Type of dimming: other, .

Artikel-Nr.	12275023	Applications
Stand:	25.11.2020 20:13	HOME LIVING OFFICE COMMUNICATION HOTEL INDUSTRY GASTRONOMY

colour of light	3000
Colour	chrome
Radiation angle	36 °
amount of light sources / fittings	1 Qty
material	Aluminium / Steel / Plastic
version	Plug&Play
Power	5,5 W
Lamp type	LED
Colour rendering	CRI > 80
Type of dimming	other

Outer diameter	90 mm
Built-in diameter	74 mm
Built-in depth	37 mm
Current	350 mA
Luminous flux	550 lm
IP protection class	IP44*
Protection class	III
Voltage type	DC
Adjustability	not adjustable
circuit type secondary side	series conduction