

## LED-Bodeneinbauleuchte HYBRIDE, V4A, IP67

## Artikel-Nr. 14671223

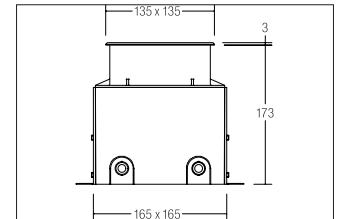

LED-Bodeneinbauleuchte HYBRIDE, V4A, IP67, stainless steel. Flush mounting, Floor-mounted. Mounting method: Flush mounting, Place of installation: Floor-mounted, material: Stainless steel / Aluminium / Glass, IP protection class: according to DIN EN 60529 IP67, Protection class: (EN 61140) I, voltage: 230V AC 50Hz, Power: 11W, amount of light sources / fittings: 1.0 Stk, Luminous flux: 550lm, Farbtemperatur: 3000K, Colour of light: white, Radiation angle: 117°, With operating gear, Type of dimming: switchable, .

|                       |                  |
|-----------------------|------------------|
| <b>Artikel-Nr.</b>    | <b>14671223</b>  |
| <b>price</b>          | 290.90 €         |
| <b>Stand:</b>         | 01.09.2020 14:28 |
| <b>Discount group</b> | Discount group 1 |

|                                    |   |
|------------------------------------|---|
| colour of light                    | 3000 K  |
| Colour                             | stainless steel   |
| Radiation angle                    | 117 °   |
| amount of light sources / fittings | 1 Qty   |
| material                           | Stainless steel / Aluminium / Glass   |
| Power                              | 11 W  |
| Lamp type                          | LED   |
| shipping                           | inkl. Konverter zum Anschluss an 230 V-Netzspannung, schaltbar, Bodeneinbautopf und 5.000 mm Anschlussleitung |
| Colour rendering                   | CRI > 80  |

|                             |                     |
|-----------------------------|---------------------|
| Type of dimming             | switchable          |
| Built-in width              | 165 mm              |
| Built-in length             | 165 mm              |
| Built-in depth              | 173 mm              |
| voltage                     | 230V AC 50Hz        |
| Luminous flux               | 550 lm              |
| Max. load                   | 1,000 kg            |
| Impact strength             | IK09                |
| IP protection class         | IP67                |
| Protection class            | I                   |
| Voltage type                | AC                  |
| Length                      | 135 mm              |
| Width                       | 135 mm              |
| circuit type secondary side | parallel conduction |