

LED-Einbaustrahler BB05, dimmbar, mit Phasenabschnitt-Konverter und Anschlussbox

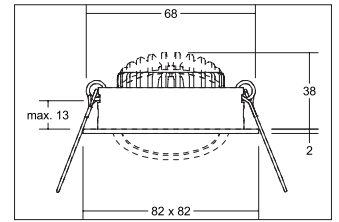
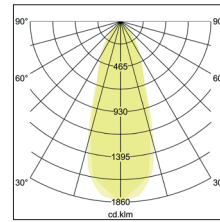

Distance (m)	Beam Diameter (m)	Luminous Flux (lm)
1.0 m	0.710.6	1184.2
2.0 m	1.411.3	296.1
3.0 m	2.111.9	131.6
4.0 m	2.812.5	74.0
5.0 m	3.513.1	47.4

LED-Einbaustrahler BB05, dimmbar, mit Phasenabschnitt-Konverter und Anschlussbox, chrome. In a compact design, for installation in tool-less rapid assembly systems. Set inkl. Konverter für 230 V-Netzspannung, Phasenabschnitt, Maße Konverter: L 110 x B 50 x H 19 mm. Mounting method: Flush mounting, Place of installation: Ceiling-mounted, material: Aluminium / Plastic, IP protection class: according to DIN EN 60529 IP20, Protection class: (EN 61140) II, voltage: 230V AC 50Hz, Power: 6W, amount of light sources / fittings: 1.0 Stk, Luminous flux: 640lm, Colour temperature: 3000K, Colour of light: white, Radiation angle: 38°, Adjustability: swivelling, With operating gear, Type of dimming: Phase cut-off, .

Artikel-Nr.	39465023	Applications
price	53.80 €	HOME LIVING OFFICE COMMUNICATION HOTEL INDUSTRY
Stand:	09.07.2020 14:27	GASTRONOMY

colour of light	3000 K
Colour	chrome
Radiation angle	38 °
amount of light sources / fittings	1 Qty
material	Aluminium / Plastic
Power	6 W
Lamp type	LED
Colour rendering	CRI > 80
Type of dimming	Phase cut-off
Built-in diameter	68 mm

Built-in depth	36 mm
voltage	230V AC 50Hz
Luminous flux	640 lm
IP protection class	IP20
Protection class	II
Voltage type	AC
Adjustability	swivelling
Length	82 mm
Width	82 mm
Swivel angle	30 °
circuit type secondary side	parallel conduction