

LED-Bodeneinbauleuchte HYBRIDE MINI, V4A, IP65

Artikel-Nr. 14051223

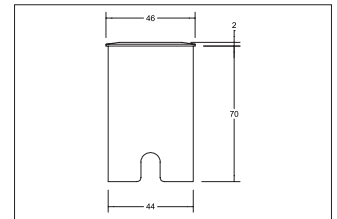

LED-Bodeneinbauleuchte HYBRIDE MINI, V4A, IP65, edelstahl, round. Flush mounting, Floor-mounted. Mounting method: Flush mounting, Place of installation: Floor-mounted, material: Stainless steel / Aluminium / Glass, IP protection class: according to DIN EN 60529 IP65, Protection class: (EN 61140) III, voltage: 24V, Power: 1,4W, amount of light sources / fittings: 1.0 Stk, Luminous flux: 3lm, Colour temperature: 3000K, Colour of light: white, Radiation angle: 100°, without operating, .

Artikel-Nr.	14051223
Stand:	25.11.2020 04:54

colour of light	3000 K
Colour	stainless steel
Radiation angle	100 °
amount of light sources / fittings	1 Qty
material	Stainless steel / Aluminium / Glass
Power	1,4 W
Lamp type	LED
shipping	inkl. 3.000 mm Anschlussleitung

Colour rendering	CRI > 80
Built-in diameter	44 mm
Built-in depth	70 mm
voltage	24V
IP protection class	IP65
Protection class	III
Voltage type	DC
circuit type secondary side	parallel conduction