

LED-Wandanbauleuchte, V4A, IP44

Artikel-Nr. 10077423

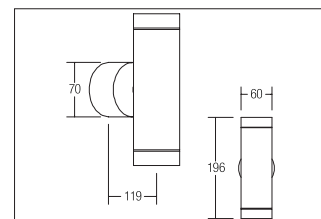

LED-Wandanbauleuchte, V4A, IP44, stainless steel. Surface mounting, Wall-mounted. Lichtaustritt direkt und indirekt. Mounting method: Surface mounting, Place of installation: Wall-mounted, material: Stainless steel / Glass, IP protection class: according to DIN EN 60529 IP44, Protection class: (EN 61140) I, voltage: 230V AC 50Hz, Power: 7,7W, amount of light sources / fittings: 2.0 Stk, Luminous flux: 490lm, Farbtemperatur: 3000K, Colour of light: white, Radiation angle: 32° , .

Artikel-Nr.	10077423
price	340.60 €
Stand:	01.09.2020 16:09
Discount group	Discount group 1

colour of light	3000 K
Colour	stainless steel
Radiation angle	32 °
amount of light sources / fit-	2 Qty
tings	
material	Stainless steel / Glass
Power	2 x 4 W
Lamp type	LED
shipping	inkl. Konverter zum Anschluss an 230 V-Netzspannung, schaltbar

Colour rendering	CRI > 80
voltage	230V AC 50Hz
Luminous flux	490 lm
IP protection class	IP44
Protection class	I
circuit type secondary side	parallel conduction