

LED-Anbaudownlight IMPLEMENT, dimmbar

Artikel-Nr. 12392173

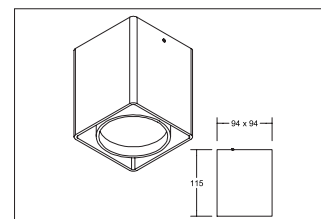

LED-Anbaudownlight IMPLEMENT, dimmbar, strukturweiß, square. Surface mounting, Ceiling-mounted. Leuchte inkl. Konverter für 230 V-Netzspannung, Phasenabschnitt. Lamp holder: without, Mounting method: Surface mounting, Place of installation: Ceiling-mounted, material: Aluminium / Plastic, IP protection class: according to DIN EN 60529 IP20, Protection class: (EN 61140) I, voltage: 230V AC 50Hz, Power: 8,9W, amount of light sources / fittings: 1.0 Stk, Luminous flux: 730lm, Farbtemperatur: 3000K, Colour of light: white, Radiation angle: 37°, Adjustability: not adjustable, With operating gear, Type of dimming: Phase cut-off, .

Artikel-Nr. 12392173
Stand: 24.11.2020 16:41

colour of light	3000
Radiation angle	37 °
amount of light sources / fittings	1 Qty
material	Aluminium / Plastic
Power	8,9 W
Lamp type	LED
shipping	inkl. Konverter zum Anschluss an 230 V-Netzspannung, dimmbar

Colour rendering	CRI > 90
Type of dimming	Phase cut-off
voltage	230V AC 50Hz
Luminous flux	730 lm
IP protection class	IP20
Protection class	I
Voltage type	AC
Adjustability	not adjustable
Height-depth	115 mm
circuit type secondary side	parallel conduction