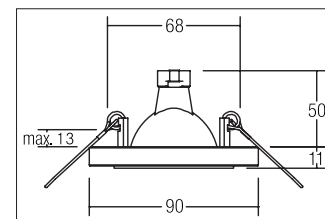
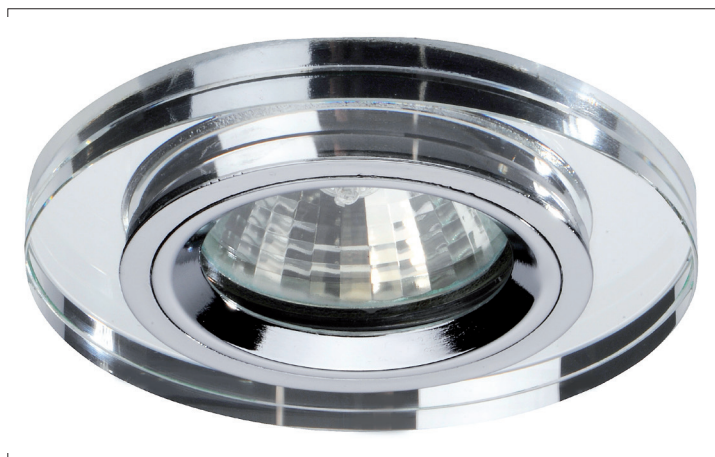

## Einbaudownlight

**Artikel-Nr. 0282.00**

Einbaudownlight, chrom, round. In a compact design, for installation in tool-less rapid assembly systems. Lamp holder: GX5.3, Mounting method: Flush mounting, Place of installation: Ceiling-mounted, material: Cast aluminium / Glass, IP protection class: according to DIN EN 60529 IP20, Protection class: (EN 61140) III, voltage: 12V, Power: max. 50W, amount of light sources / fittings: 1.0 Stk, Adjustability: not adjustable, without operating, Type of dimming: other, .

<b>Artikel-Nr.</b>	<b>0282.00</b>
<b>Stand:</b>	25.11.2020 23:48

Colour	chrome
amount of light sources / fittings	1 Qty
Type of dimming	other
Outer diameter	90 mm
Cool beam	No
Built-in diameter	68 mm
Built-in depth	50 mm
material	Cast aluminium / Glass
Height-depth	10 mm

version	GX5.3
Power	max. 50 W
voltage	12V
Lamp type	LV halogen lamp
circuit type secondary side	parallel conduction
IP protection class	IP20
Protection class	III
Voltage type	AC/DC
Circlip	without circlip
Adjustability	not adjustable