

LED-Bodeneinbauleuchte HYBRIDE, V4A, IP67

Artikel-Nr. 14670223

Licht.
Für Generationen.

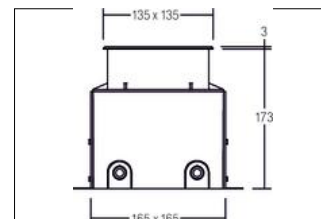

LED-Bodeneinbauleuchte HYBRIDE, V4A, IP67, stainless steel. Flush mounting, Floor-mounted. . Mounting method: Flush mounting, Place of installation: Floor-mounted, material: Stainless steel / Aluminium / Glass, IP protection class: according to DIN EN 60529 IP67, Protection class: (EN 61140) I, voltage: 230V AC 50Hz, Power: 9 W, Luminous flux: 460.0 lm, colour of light: 3000 K, Colour of light: white, Radiation angle: 40.0 °, With operating gear: Yes, Type of dimming: switchable, Energy efficiency class: A++ to A,

Artikel-Nr.	14670223
price	305.00 €
Stand:	27.08.2019 14:38

colour of light	3000 K
Colour	stainless steel
Radiation angle	40 °
amount of light sources /	1 Qty
material	Stainless steel / Aluminium
Power	9 W
Lamp type	LED
shipping	inkl. Konverter zum Anschluss
Colour rendering	CRI > 80
Type of dimming	switchable
Built-in width	165 mm
Built-in length	165 mm

Built-in depth	173 mm
voltage	230V AC 50Hz
Luminous flux	460 lm
Max. load	1,000 kg
Impact strength	IK09
IP protection class	IP67
Protection class	I
Voltage type	AC
Energy efficiency class	A++ to A
Length	135 mm
Width	135 mm
circuit type secondary side	parallel conduction